

LOS

LIGHTING

HOL

FURNITURE





Un'agenzia multidisciplinare  
di rappresentanza,  
progettazione e consulenza  
di illuminazione e arredamento.



[www.losproject.it](http://www.losproject.it)

## L'Agenzia

Agency

Un team di professionisti, architetti e lighting designer, con un'importante esperienza nel settore, in grado di offrire progetti e soluzioni di illuminazione e arredamento ai propri dealer. Soluzioni con tecnologie innovative e complementi esclusivi, grazie ad un bouquet di brand italiani ed internazionali di indiscusso prestigio.

L'Agenzia opera con un proprio ufficio tecnico, in grado di rispondere con puntualità a tutte le esigenze progettuali dei propri rivenditori.



*A team of professionals, architects and lighting designers with a significant (essential) experience in the field, able to offer lighting and furniture projects to their own leaders. Solutions with innovative technologies and unique accessories, thanks to a "bouquet" of italian and international brands of undisputed (uncontested) prestige.*

*The agency works with its own technical department, capable of responding promptly to all the design requirements of its dealers.*

LOS

LIGHTING

HOL

FURNITURE

**Lorenzo Lecci**

CEO

**Furio Orlando**

CEO

**Alessandro Scuderi**

CEO

---

## STRUTTURA AGENZIA

---

**DIVISIONE COMMERCIALE**  
SUPPORTO RETAIL

**Vincenzo Cifalà**  
Responsabile ufficio commerciale

**Luca Garozzo**  
Commerciale

---

**LIGHT & FURNITURE DIVISION**  
PROGETTAZIONE - CONTRACT

**Ing. Giulia La Ganga Vasta**  
Lighting designer

**Ing. Concetta Cavallaro**  
Lighting designer

**Ing. Silvia Spina**  
Lighting designer

**Ing. Rossella Grasso**  
Lighting designer

---

**DIVISIONE AMMINISTRATIVA**

**Giorgio Bottitta**  
Responsabile ufficio amministrativo  
SMM

# I Progetti

Project Categories



BUSINESS



RESIDENTIAL



HOSPITALITY



WELLNESS



SHOPPING CENTERS



SPORT FACILITIES



CAR DEALERS



SHOPS



OFFICES



OUTDOOR



RESTAURANTS

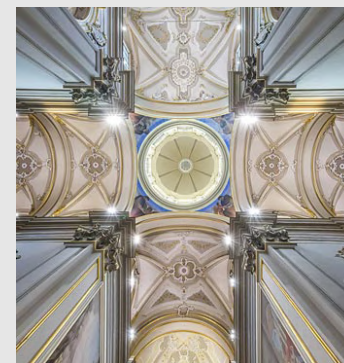

PUBLIC WORKS

# Brands



# Brand



FLOS



FLOS  
ARCHITECTURAL

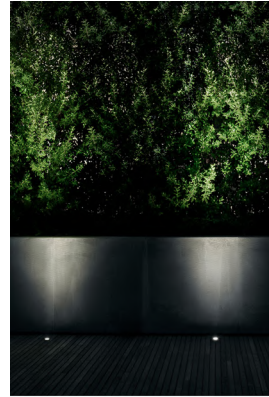

FLOS  
OUTDOOR



PHILIPPO  
FLOS/OMI MADE IN ITALY



Molteni&C



Dada



PORCELANOSA Grupo



MAGIS



louis  
poulsen



vitra.  
artek



linealightgroup



linealightindustrial



MOD



DEDON



RODA



Jacuzzi



UniFor

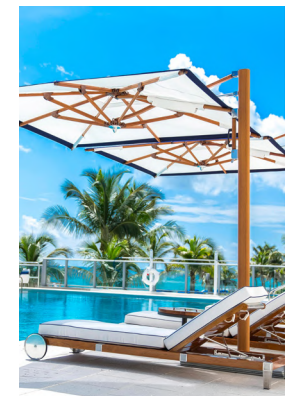

TUUCI

FLOS





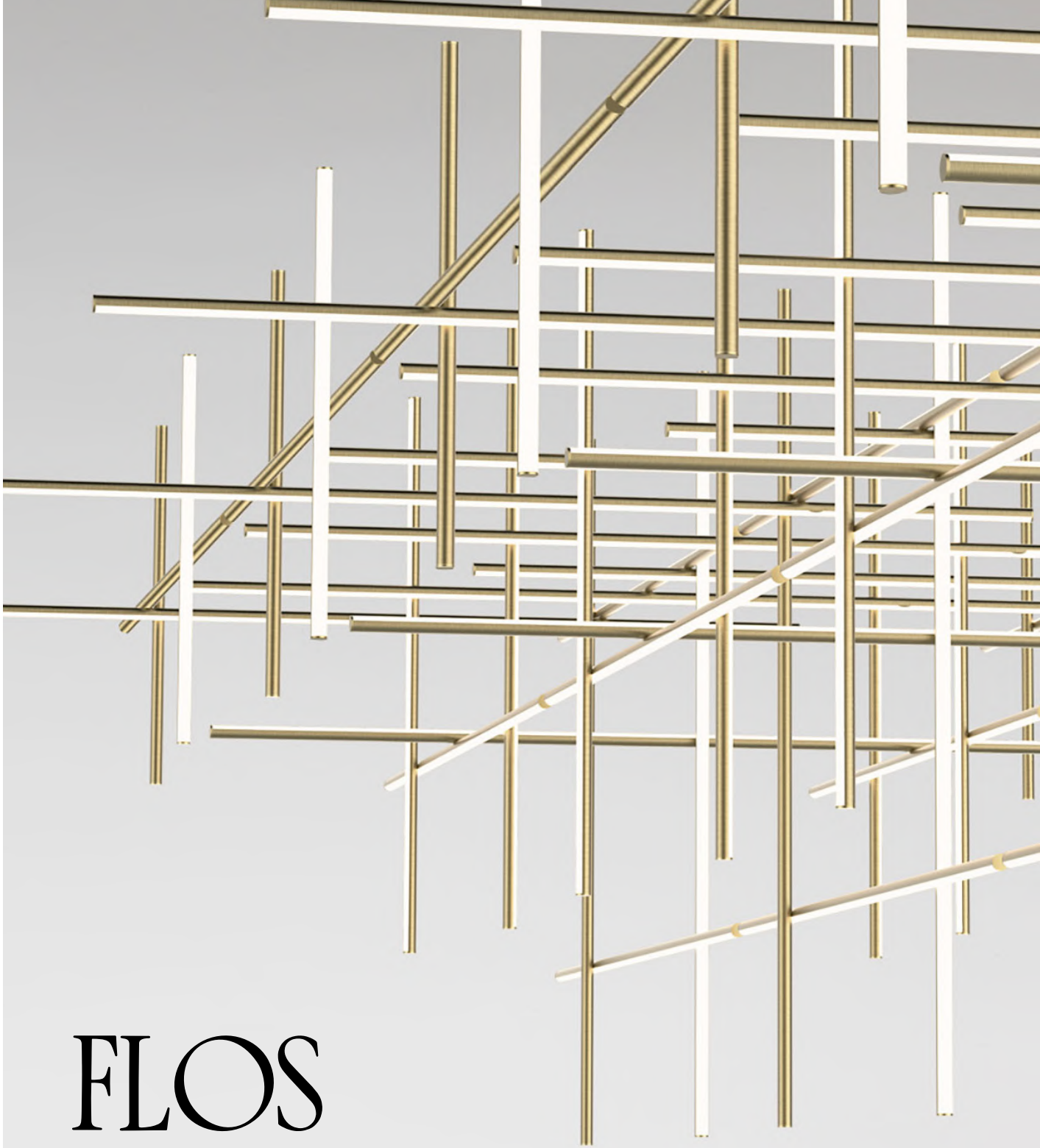

FLOS

KUNG  
WEG

**vitra.**



Molteni & C





**Dada**

**FLEXFORM**







R | O | D | A

MAGIS





# Progettazione

LOS

LIGHTING

HOL

FURNITURE

# Progetti illuminotecnici



# Progetti illuminotecnici

HOTEL MALTA

MALTA  
2019

LOS LIGHTING  
HOL FURNITURE

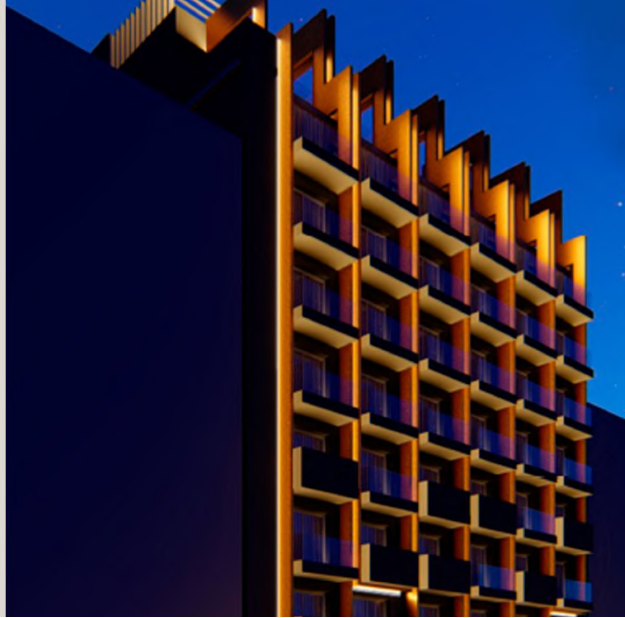

LIGHTING

FURNITURE

gli ESTERNI

la VERIFICA ILLUMINOTECNICA

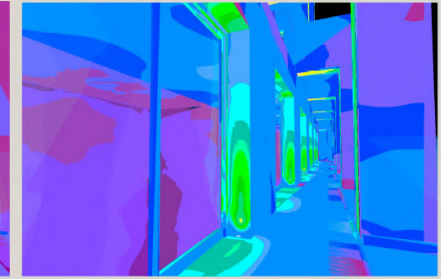
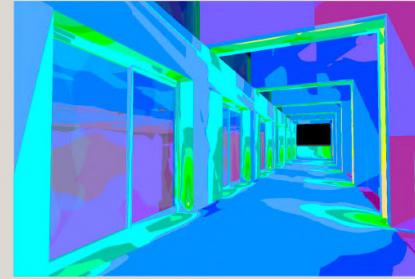
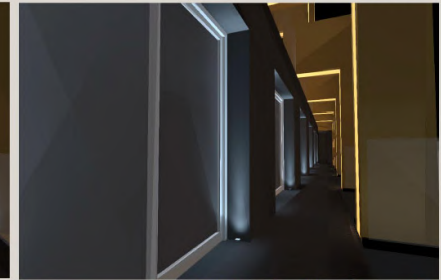
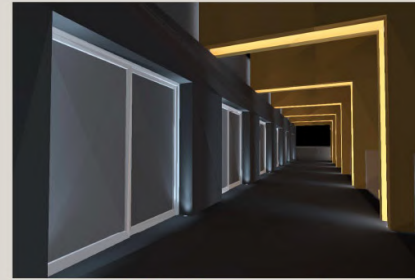

la VERIFICA ILLUMINOTECNICA la SALA COLAZIONE



LIGHTING

FURNITURE

posizionamento CORPI ILLUMINANTI

le CAMERE

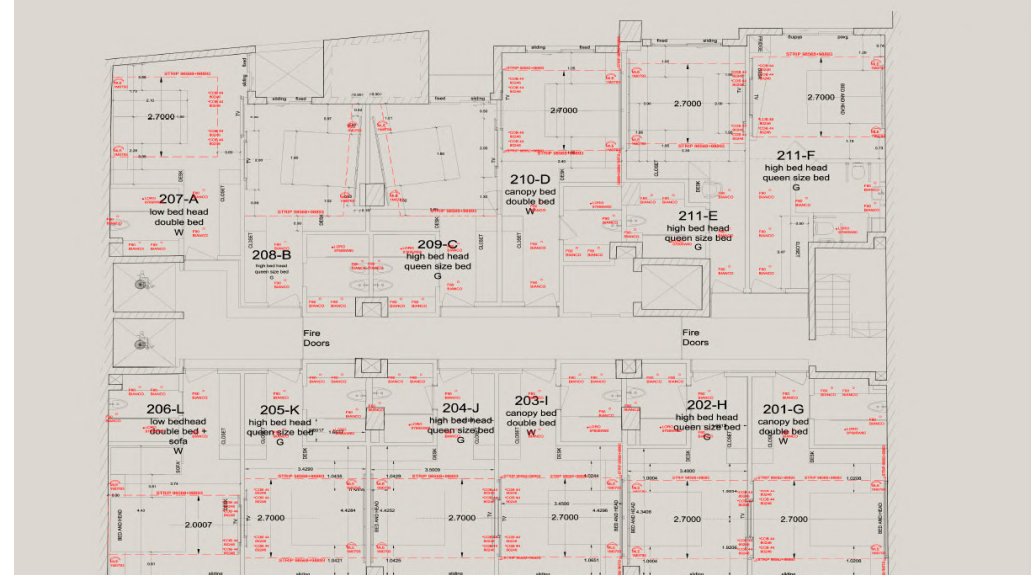

# Progetti illuminotecnici

The image displays a comprehensive lighting design project. At the top left is a detailed architectural floor plan of a building, with various rooms and corridors outlined. To the right of the plan is a large table, likely a lighting schedule or fixture specification table, with multiple columns and rows of data. Below the floor plan is a large, colorful lighting layout. This layout shows a top-down view of the space with a color gradient representing light intensity, ranging from purple (low) to red and yellow (high). A red circle highlights a specific area on the layout. To the right of the lighting layout are two technical data sheets for 'DALI 10 HALOSPOT-EL-F50 WINKEL / Luminare Data Sheet'. Each sheet includes a product image, a beam diagram showing the light distribution pattern, and a table of photometric data. The rightmost sheet also features a room layout with light distribution curves and a table of calculated lighting values. At the bottom right, three small inset photographs show the final lighting effects in a retail or gallery space, including a display of clothing and a long hallway with a red carpet.

# Progetti illuminotecnici

## PIANTA PIANO COPERTURA

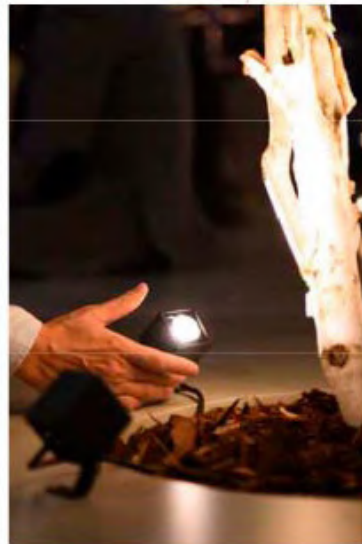
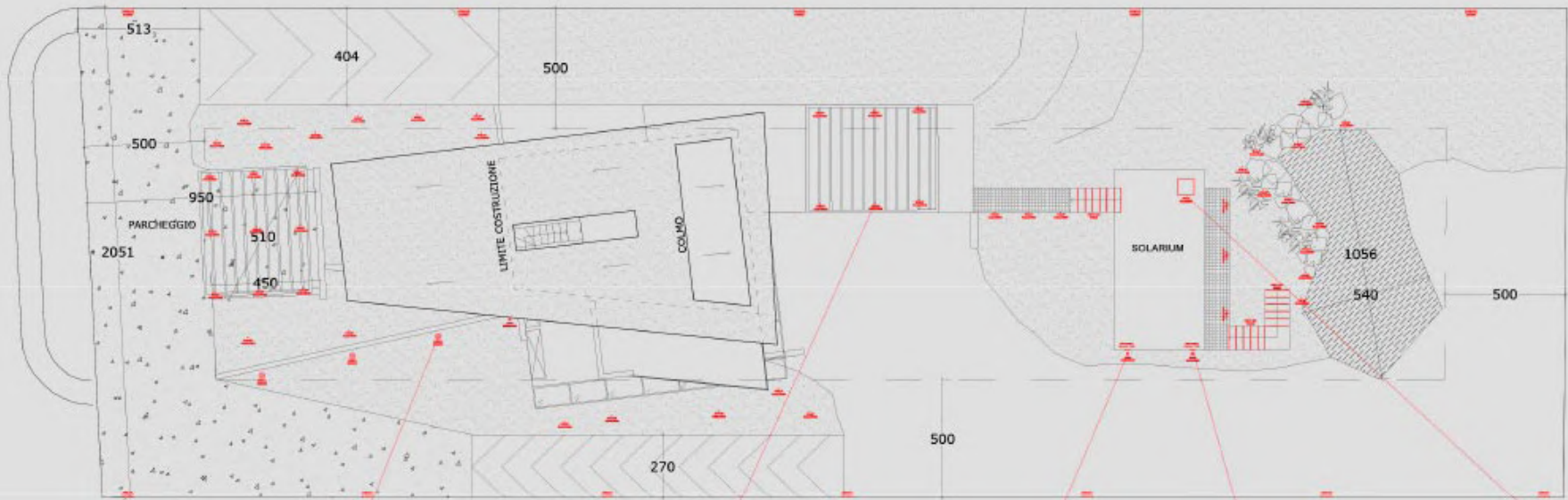

# Realizzazioni

**LOS**

LIGHTING

**HOL**

FURNITURE



URAMAKAO  
URAMAKERIA DO BRAZIL























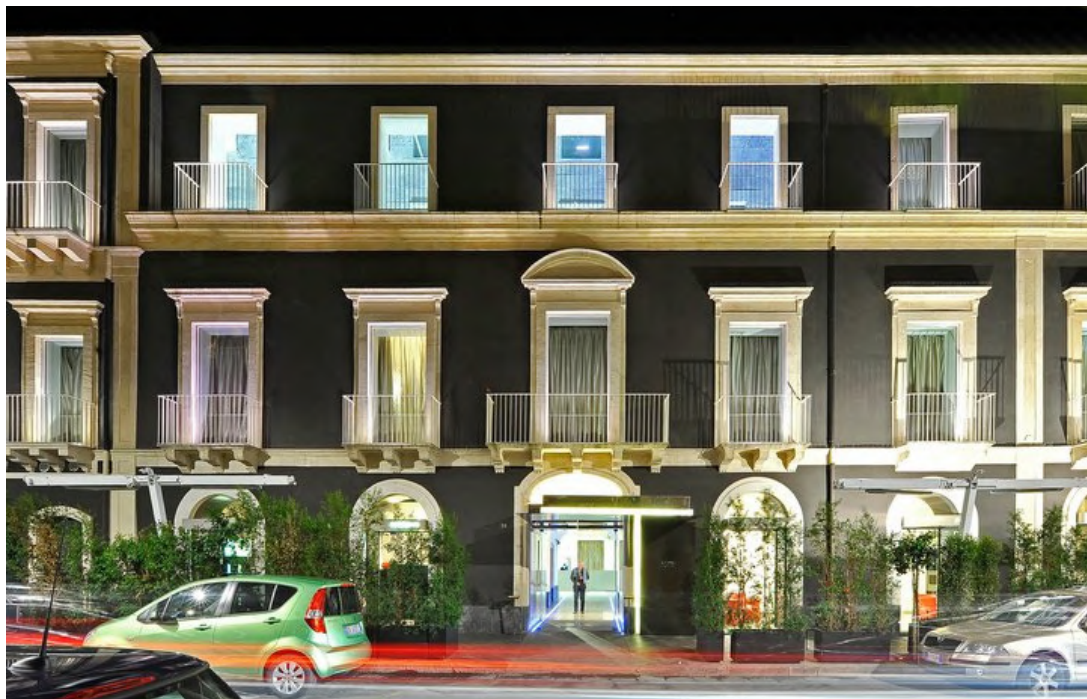







[www.losproject.it](http://www.losproject.it)

Via Medea 11/C  
95129 Catania - ITALY

Tel. +39 095 7128342  
[info@losproject.it](mailto:info@losproject.it)

